

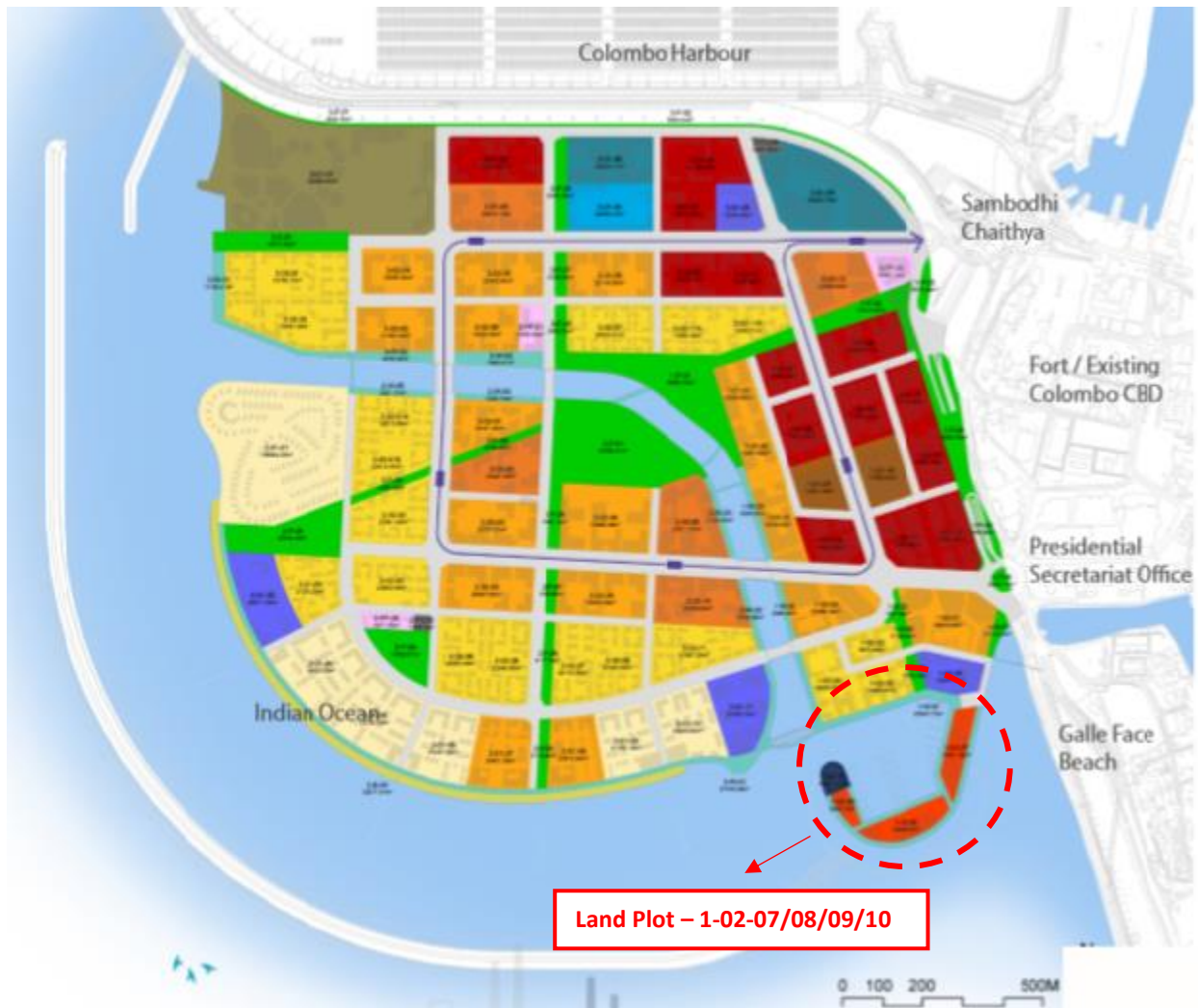

PORT CITY COLOMBO
CHEC PORT CITY COLOMBO (PVT) LTD

Land Plot Introduction

“MARINAPLOT 1-02-07/08/09/10” at PORT CITY COLOMBO



Project Background

Port City Colombo was identified as one of the priority projects in the Central Business District and the Colombo Metro Area (CMA). In 2014, the Port City Master Plan was prepared for the 269.3 ha reclaimed site. The plan aims to innovate and design a new world-leading city development based on best international experience, especially adapted to the Sri Lankan context and the site specific conditions. The new city will tap into the intrinsic values of the region and environment to create an ideal modern community for business, living and leisure.

Project Framework

The COLOMBO PORT CITY Master Plan will provide detailed land use regulations and development control regulations (DCR) to ensure all participants in the development of Colombo Port City, including architects, designers, builders, developers and operators contribute to the realization of the desired vision and character for the new city.

Overview - Plot 01-02-07/08/09/10

The plots will be developed as leisure destinations for both office workers in the CBD and residents from the whole Colombo. Restaurants, entertainment and retail are located in small scale buildings on the pier. The development will be organized to create small intimate internal streets and cozy eating outlets. The marina is envisioned to be a place for all age groups with engaging activities, ocean view and City view including leisure boating.

Plot Regulations

Plot Number /s	1-02-07/08/09/10
Plot Area	10,361.32 m ² (1-02-07) 12,489.37 m ² (1-02-08) 3,546.19 m ² (1-02-09) 4,379.12 m ² (1-02-10)
land Use	Marina Commercial (1-02-07/08/09) Marina Facility (1-02-10)
Floor Area Ratio (FAR)	Max. 1.0
Building Height	Max. 20.0 m Max 3 Floors
Building Coverage	Max. 50% (1-02-07/08/09) Max 40% (1-02-10)

Landscape Coverage	
Total Landscape Coverage	Min. 35% of Plot Area (1-02-07/08/09) Min. 25% of Plot Area (1-02-10)
Ground Level Landscape	Min. 15% of Plot Area (1-02-07/08/09) Min. 20% of Plot Area (1-02-10)

Permissible Gross Floor Area	
Total GFA	Max. 10,361.32 m ² (01-02-07)
	Max. 12,489.37 m ² (01-02-08)
	Max. 3,546.19 m ² (01-02-09)
	Max. 4,379.12 m ² (01-02-10)
Retail Use	Min. 50% of Total GFA (1-02-07/08/09) (Refer Uses Matrix/Appendix II for Permitted uses for plot 1-02-10)
Other Uses	The remainder GFA can be developed for other permitted uses as per the Uses Matrix (Appendix II).

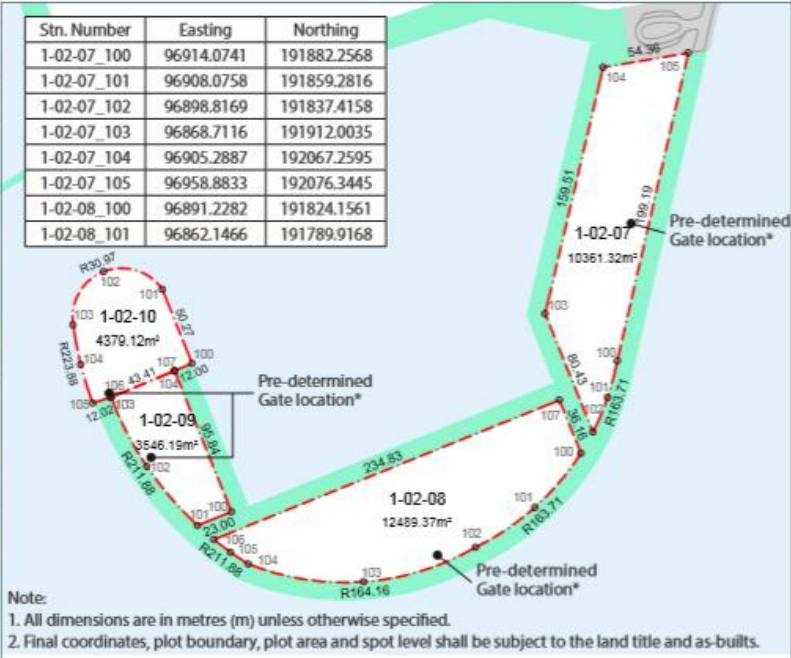

Eligibility criteria

Any interested local or international Leisure and Retail Developers / Investors

Disclaimer

The information contained in this document is for general information only and nothing in this document contains professional advice or an offer for sale or any binding commitment upon CHEC Port City Colombo (Private) Limited in relation to the availability of property or the description of property. It does not constitute part of a legal offer or contract. All information contained herein shall be subject to final approval by the Government of Sri Lanka and related legal documentation. Due to CHEC Port City Colombo (Private) Limited's policy of continuous improvement, it reserves the right to modify any parts of the information contained herein from time to time. The reader must verify all the details and specifications, including but not limited to the area, specifications, services, terms of sales, payments and all other relevant terms independently with our sales/ marketing team prior to concluding any decision for buying a plot at Port City Colombo.

Whilst every reasonable care has been taken in preparing this document, CHEC Port City Colombo (Private) Limited nor any of its officers, employees, consultants or representatives shall be held responsible for any inaccuracies in its content.

All proposals will be treated and assured confidentiality

Any interested local or foreign party may contact The Managing Director, CHEC Port City Colombo (Pvt) Ltd to be sent via register post, e-mail or courier.

CHEC Port City Colombo (Pvt) Ltd

4th & 5th Floors,

Central Point Building,

No. 54 Chatham Street,

Colombo 01

Sri Lanka

E-Mail – enquiry@chec.lk

Phone Enquiries - +94 117 22 00 88 / +94 77 838 8888



CHEC PORT CITY COLOMBO (PVT) LTD.